

THE RIB STRINGING DIAGRAMS BELOW ARE FOR RIBS & NOSE RIBS, THE STRINGINGS OF WHICH ARE THE SAME PORT & STBD.

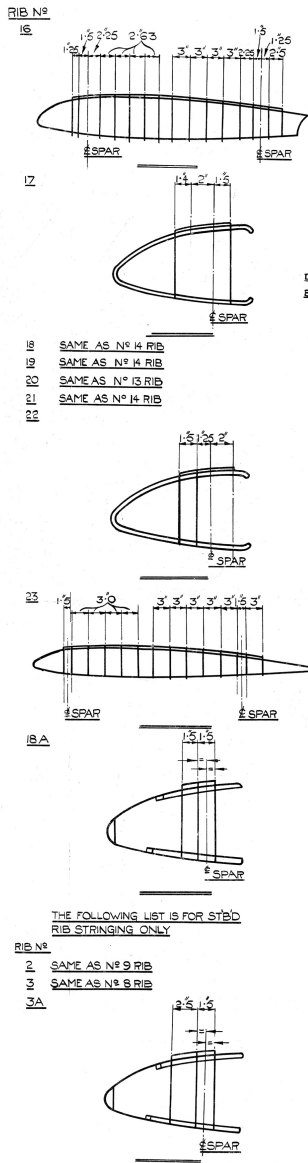

THE FOLLOWING LIST IS FOR PORT RIB STRINGING ONLY.

THE FOLLOWING LIST IS FOR PORT RIB STRINGING ONLY.

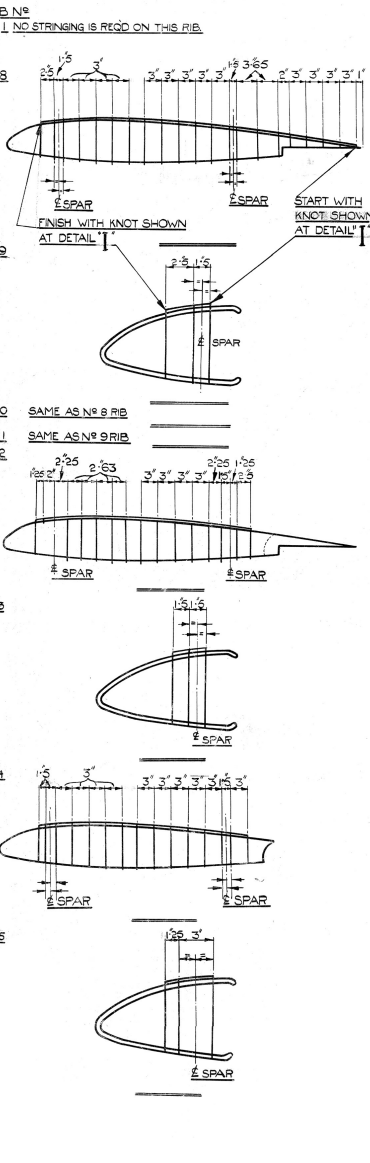
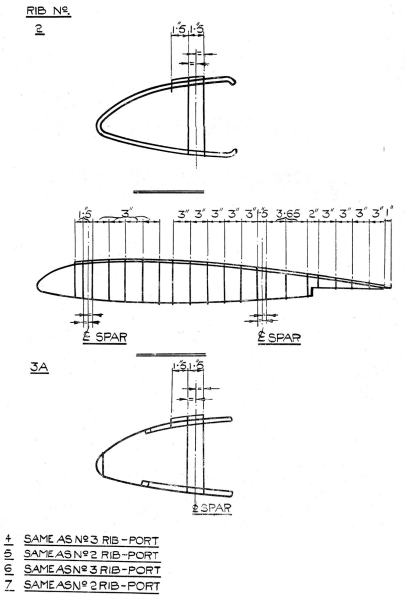

THE FOLLOWING LIST IS FOR STBD RIB STRINGING ONLY.

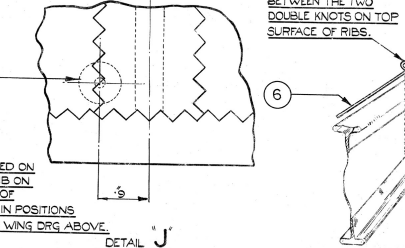

PART N° JA80547/L DRG N° E.H.73/L AS DESCRIBED - PORT;
PART N° JA80547/R DRG N° E.H.73/R AS DESCRIBED - STBD.

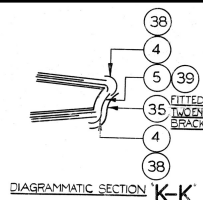

DIAGRAMMATIC SECTION K-K

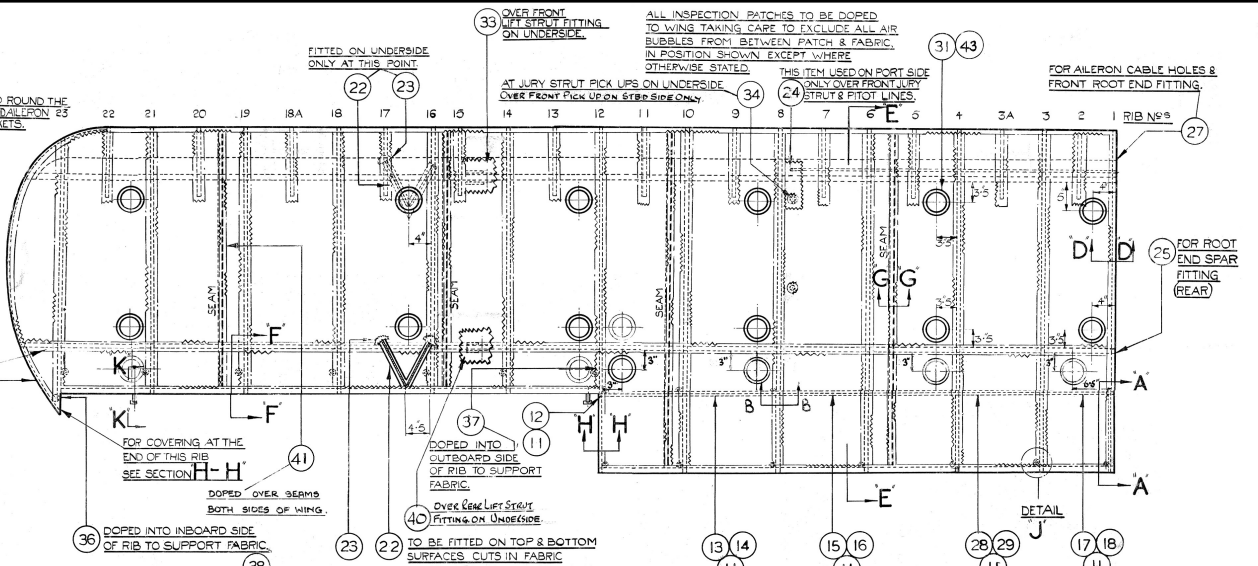

SECTION C-C SHOWING COVERING

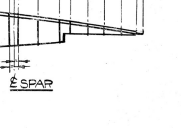

SECTION D-D



SECTION E-E

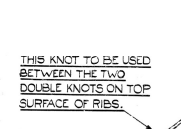

SECTION G-G

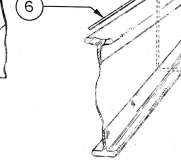

SECTION H-H

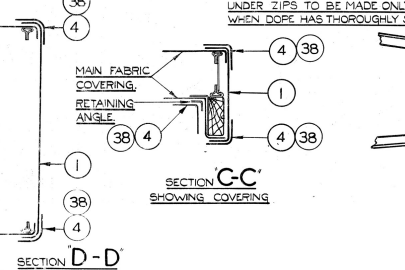

SECTION A-A COVERING NOT SHOWN

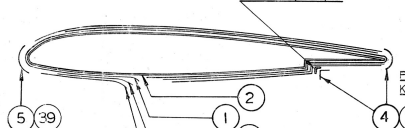

SECTION B-B

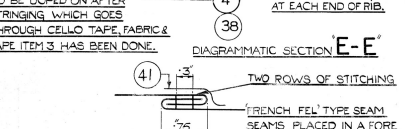

SECTION F-F

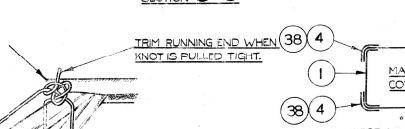

SECTION J

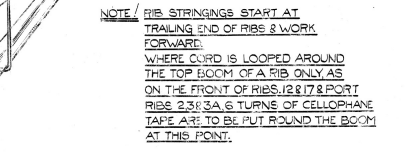

SECTION J

ALL INSPECTION PATCHES TO BE DOPED TO WING TAKING CARE TO EXCLUDE ALL AIR BUBBLES FROM BETWEEN PATCH & FABRIC IN POSITION SHOWN EXCEPT WHERE OTHERWISE STATED.

THIS ITEM USED ON PORT SIDE ONLY OVER FRONT JURY STRUT & PITOT LINES.

FOR AILERON CABLE HOLES & FRONT ROOT END FITTING.

FOR ROOT END SPAR FITTING (REAR).

TO BE FITTED ON TOP & BOTTOM SURFACES CUTS IN FABRIC UNDER ZIPS TO BE MADE ONLY WHEN DOPE HAS THOROUGHLY SET.

TO BE DOPED ON AFTER STRINGING WHICH GOES THROUGH CELLO TAPE, FABRIC & TAPE ITEM 3 HAS BEEN DONE.

TO BE DOPED ON UNDERSIDE OF MAINPLANE IN POSITIONS SHOWN ON WING DRG ABOVE.

TO BE DOPED OVER FABRIC ON BOTH SIDES OF WING.

DOPED INTO INBOARD SIDE OF RIB TO SUPPORT FABRIC.

DOPED OVER BEAMS BOTH SIDES OF WING.

DOPED INTO OUTBOARD SIDE OF RIB TO SUPPORT FABRIC.

OVER REAR LEFT STRUT FITTING ON UNDERSIDE.

TO BE FITTED ON TOP & BOTTOM SURFACES CUTS IN FABRIC UNDER ZIPS TO BE MADE ONLY WHEN DOPE HAS THOROUGHLY SET.

TO TERMINATE WITH LAST KNOTS AT EACH END OF RIB.

TRIM RUNNING END WHEN KNOT IS PULLED TIGHT.

THIS KNOT TO BE USED BETWEEN THE TWO DOUBLE KNOTS ON TOP SURFACE OF RIBS.

TO BE DOPED ON AT EACH RIB ON UNDERSIDE OF MAINPLANE IN POSITIONS SHOWN ON WING DRG ABOVE.

IT IS IMPORTANT THAT HOLES IN ANGLE PICK-UP WING RIBS AS SHOWN.

REST OF COVERING FOR SHORT RIBS SAME AS FOR LONG RIBS.

GENERAL NOTES

- FABRIC TAPES & PATCHES ETC. TO BE WELL DOPED TO WING FRAME AND/OR TOGETHER WITH CLEAR DOPE FOR NORMAL PRODUCTION FABRIC INSIDE PATCHES ITEM 3 IS NOT TO BE CUT BUT WHEN IT BECOMES NECESSARY TO INSPECT THE FRAME A HOLE COINCIDING WITH INSIDE OF THE INSPECTION PATCH IS TO BE CUT AND RECOVERED WITH PATCH ITEM 3 DOPE CENTRALLY OVER HOLE AFTER INSPECTION.
- ITEM 2 IS TO BE USED TO COVER RIBS AND NOSE RIBS & PARKER KALON SCREWS BUT NOT OVER SCREWS SECURING AILERON GAP SHARLOUS.
- ALL CORD USED FOR STRINGING TO BE BEESWAXED.
- ITEMS 9 & 30 ARE ALTERNATIVES.
- N° 42 DRILL HOLES TO BE USED FOR PK SCREWS.
- ITEMS 4 & 38 ARE ALTERNATIVE & ITEMS 5 & 39 ARE ALTERNATIVE.

NOTE / RIB STRINGINGS START AT TRAILING END OF RIBS & WORK FORWARD WHERE CORD IS LOOPED AROUND THE TOP BOOM OF A RIB ONLY AS ON THE FRONT OF RIBS 2, 3 & 17 & PORT RIBS 2, 3 & 3A 5 TURNS OF CELLOPHANE TAPE 2.1 TO BE PUT ROUND THE BOOM AT THIS POINT.

TO BE DOPED ON AT EACH RIB ON UNDERSIDE OF MAINPLANE IN POSITIONS SHOWN ON WING DRG ABOVE.

TO BE DOPED ON AT EACH RIB ON UNDERSIDE OF MAINPLANE IN POSITIONS SHOWN ON WING DRG ABOVE.

TO BE DOPED ON AT EACH RIB ON UNDERSIDE OF MAINPLANE IN POSITIONS SHOWN ON WING DRG ABOVE.

TO BE DOPED ON AT EACH RIB ON UNDERSIDE OF MAINPLANE IN POSITIONS SHOWN ON WING DRG ABOVE.

QTY	ITEM NO.	DESCRIPTION	REF. NO.	UNIT	AS REQ.
44					
43	J81539	PATCH	AJH 415	19 LH/R	
42		1 1/2" SERRATED TAPE	DTD 540, 575 OR 407	AS REQ.	
40	J82124	PATCH REAR	AJH 694	1 LH/R	
39		4" SERRATED TAPE	DTD 540, 575 OR 407	AS REQ.	
38		2" SERRATED TAPE	DTD 540, 575 OR 407	AS REQ.	
37	J80390	REINFORCEMENT	AJH 37	1 LH/R	
36	J80389	REINFORCEMENT	AJH 36	1 LH/R	
35	J50260	PATCH	AJE 45	2 LH/R	
34	J16880	PATCH	AJA 2808	1 LH/R	
33	J82123	PATCH, FRONT	AJH 693	1 LH/R	
32	J80723	FABRIC PATCH	AJH 81	SEE NOTE	
31	J8104	INSPECTION PATCH	ADH 110	19 LH/R	
30	AG5840	DRAIN EYELET		3 LH/R	
29	J80179/R	FABRIC RETAINING ANGLE	CEH 180/L	1 RH	
28	J80179/L	FABRIC RETAINING ANGLE	CEH 180/L	1 LH	
27	J80726	PATCH	AJH 78	1 LH/R	
26					
25	J80702	FABRIC PATCH	AJH 77	1 LH/R	
24	J82122	PATCH	AJH 632	1 LH	
23	E10874	PATCH	AEA 205	7 LH/R	
22	J411846	INSPECTION PANEL	DJA 368	3 LH/R	
21	AG5252/J	WOODSCREWS		3 LH/R	
20	J80165/R	FABRIC RETAINING ANGLE	AEH100/R	1 RH	
19	J80165/L	FABRIC RETAINING ANGLE	AEH100/L	1 LH	
18	J80289/R	FABRIC RETAINING ANGLE	AEH161/R	1 RH	
17	J80289/L	FABRIC RETAINING ANGLE	AEH161/L	1 LH	
16	J80378/R	FABRIC RETAINING ANGLE	CEH159/R	1 RH	
15	J80378/L	FABRIC RETAINING ANGLE	CEH159/L	1 LH	
14	J80377/R	FABRIC RETAINING ANGLE	CFH158/R	1 RH	
13	J80377/L	FABRIC RETAINING ANGLE	CFH158/L	1 LH	
12	J80176	FABRIC RETAINING ANGLE	AEH157	1 LH/R	
11	TYPE X HEAD M	PARKER KALON SCREWS, NO. 4, X 1/4" LG		54 LH/54 RH	
10					
9	A8028	DRAIN EYELET	AGH 133	21 LH/21 RH	
8	J80446/L	WING FRAME ASSY	EJH 71/L	1	
7	J80446/R	WING FRAME ASSY	EJH 71/R	1	
6		NO. 1. BRAIDED CORD	B55 35/2	AS REQ.	
5		4" SERRATED TAPE	DTD 407	AS REQ.	
4		2" SERRATED TAPE	DTD 407	AS REQ.	
3		TAPE	DTD 773	AS REQ.	
2		CELLOPHANE TAPE		AS REQ.	
1		FABRIC	DTD 575	AS REQ.	

PROTECTIVE TREATMENT	ASSY. NO.	EJH 744/R	ITEM NO.	PART NO.	DESCRIPTION	TRACED
	EJH 73	ASK 2517	ASK 2324			
				DRAWN	CHECKED	
					STRESS	
TAYLORCRAFT AEROPLANES (ENGLAND) LTD. LEICESTER						PART NO. JA 80547/L/R
TITLE: FABRIC COVERING WING						DRG. NO. EJH 72/L/R

MOD. NO.	INTERNAL MOD. NO.	INTERNAL CLASS	APP. RTO

TYPE: CIVIL AIRCRAFT