

- 1 DO NOT SCALE DRAWING
2. ENGLISH PROJECTION IS USED UNLESS OTHERWISE STATED.
3. TOLERANCES ON DIMENSIONS ARE + OR - .01 UNLESS OTHERWISE STATED
- 4 IF IN DOUBT ABOUT THIS DRAWING, RING DRAWING OFFICE BEFORE COMMENCING OPERATIONS.

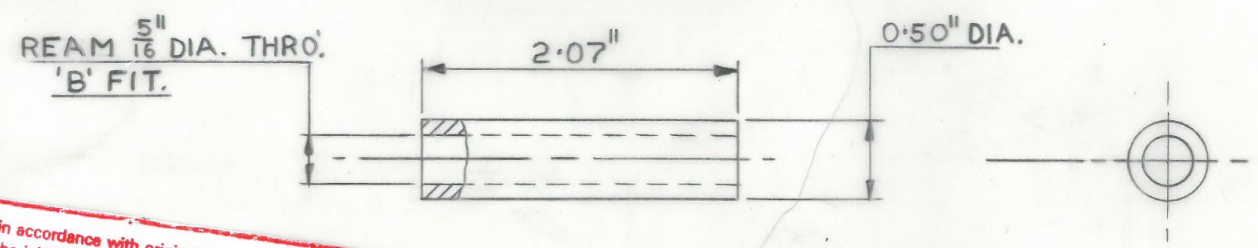

This drawing is provided in accordance with original Auster/Beagle applicability for use with the initial enquirers' aircraft ONLY.
CORRECT APPLICATION TO THE AIRCRAFT IS THE RESPONSIBILITY OF THE ENQUIRER AND HIS ENGINEER AND NOT OF "AUSTER SPARES" OR LEICESTERSHIRE MUSEUMS.
 Its supply does not confer any right to produce and trade in any of the components. Enquiries for these should be sent to:-
"Auster Spares", Carr Farm, Thorney, Newark, Notts., NG23 7DQ, England
 Tel: --- 0162 2779617



						2									
						1	BAR 1/2" DIA.		SSS1666		/				
						ITEM No.	PART No.	DESCRIPTION		MATERIAL OR DRG. NO.		No. Off			
A	CIVIL MOD	4187				EJA 3189		SCALE:-FULL SIZE		DRAWN:-13-1-67 J.WHARTON		CHECKED: 10-2-67 M.G. RUSSELL	TRACED:-	TRACING CHECKED	
ISSUE	MOD. NO.	INTERNAL MOD. No.	INTERNAL CLASS	APP.	R.T.O.	PROTECTIVE TREATMENT B + K		BEAGLE-AUSTER AIRCRAFT LTD. REARSBY, LEICESTER.		PART No. J 18779		DRG. No. AJA 3193.			
						TYPE:- MK. 5.		TITLE:- DISTANCE TUBE.		STRESS APPROVAL		DESIGN APPROVAL		APPROVED R.T.O.	